

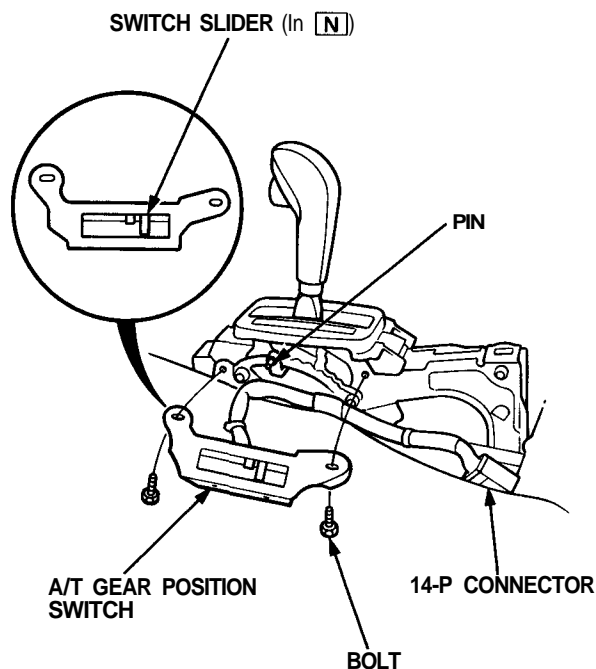

A/T Gear Position Switch Replacement

1. Remove the console, then disconnect the 14-P connector from the A/T gear position switch.
2. Remove the two mounting bolts.



3. Position the slider on the new switch to **N** as shown.

4. Shift the shift lever to **N**, then slip the switch into position.
5. Attach the switch with the two bolts.
6. Test the switch in **P** and **N**. You should be able to start the engine with the shift lever in **N** anywhere in the range of free play.
7. Connect the 14-P connector, clamp the harness, and install the console.